

ESTETIC 80/A

Hinge dimensions

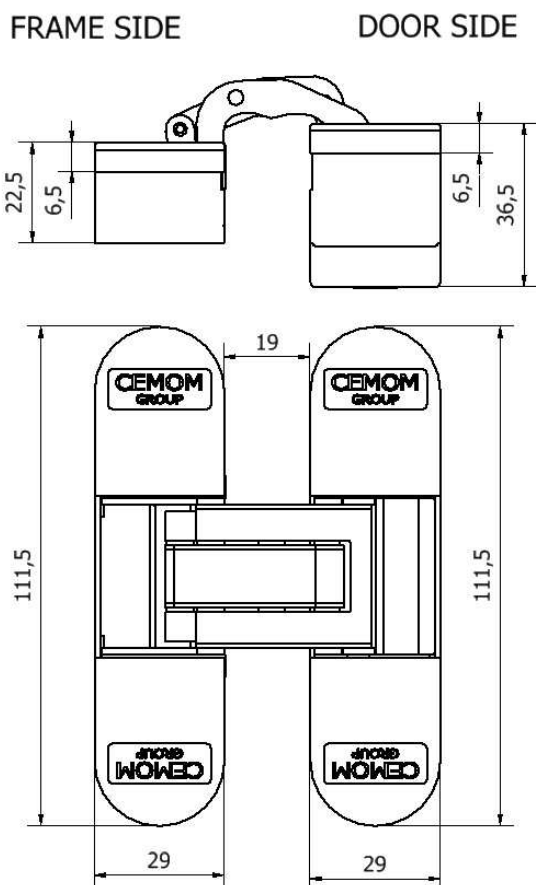

Load capacity

With correct adjustment (all hinges carrying the load), the suggested admissible weight of a door depending on the number of hinges and the door width, at the wing height of 2000 mm minimum has been presented in the table. The first door should always be checked.

Number of hinges	width DOOR "L" [mm]				
	600	700	800	900	1000
2	92 kg	88 kg	84 kg	80 kg	72 kg
3	104 kg	100 kg	96 kg	90 kg	80 kg
4	114 kg	110 kg	106 kg	100 kg	90 kg

Milling dimensions

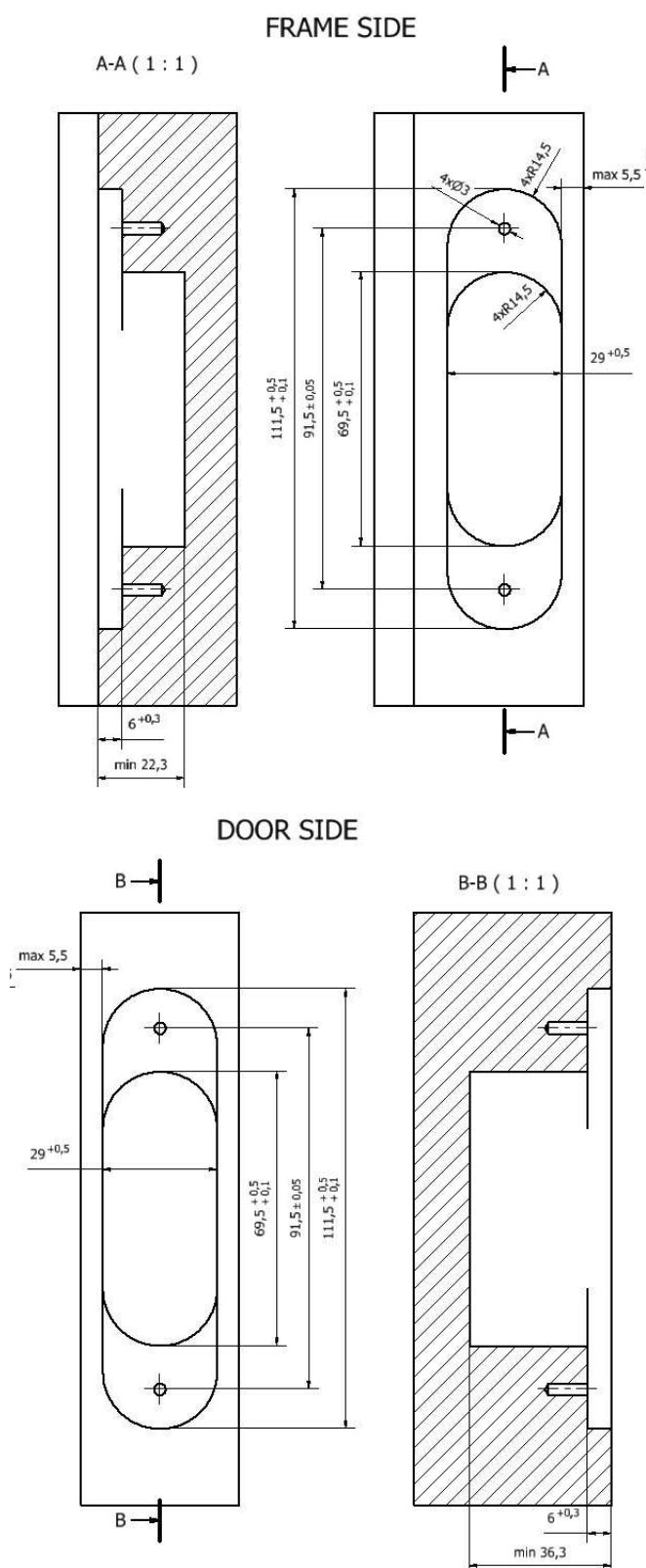

Position of the hinge in relation to the required dimensions of the door and the frame

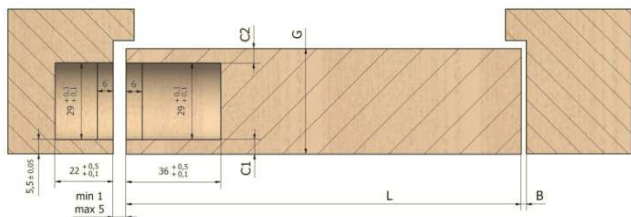

Thickness of the door "G" [mm]	C1 [mm]	C2 [mm]	Width of the door "L" [mm]			
			700	800	900	1000
			Minimum gap "B" [mm]			
40	5,5	5,5	2	2	2	2
60	5,5	25,5	4	3	3	3
80	5,5	45,5	6	5	5	4

Fitting

First insert part of hinge with marked "door" into the socket in the door in corrected position and fix the hinge by screwing two screws d.5 x min. 35 mm. Then set the door on the frame by inserting frame part of the hinge into the socket and fix the hinge by screwing two screws d.5 x min. 35 mm. Make adjustments and at the end insert the front covers to hide all screws. If you need to remove the front covers, do it carefully.

Arrangement of the hinges

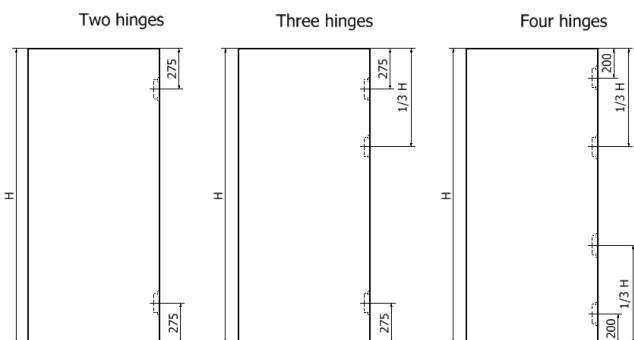

Hmin = 2000

Adjustments

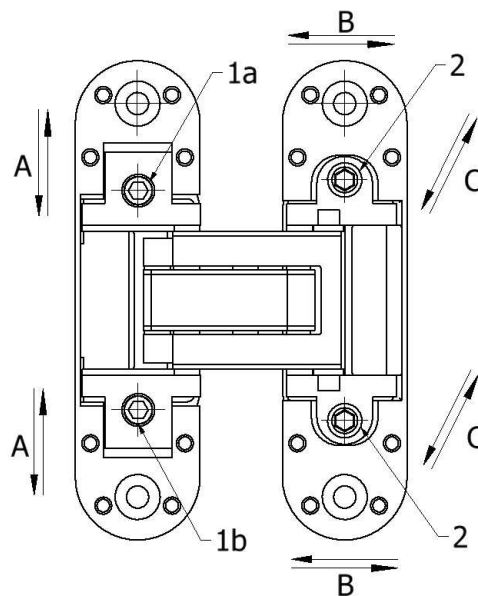

To make adjustments will be needed 4 mm Allen key. Adjustment is corrected when all hinges carrying the load.

A – vertical adjustment – range ± 2 mm

First make sure that the top adjustment screw (1a) is on par with the front surface of the hinge - if not unscrew it for this position. Adjust the hinge by turning bottom adjustment screw (1b). After finished adjustment tighten the top adjustment screw (1a).

B – depth adjustment – range ± 1 mm

C – horizontal adjustment – range ± 2 mm

Depth adjustment and horizontal adjustment takes place simultaneously. Adjust the hinge by turning alternately of both eccentric screws (2).

